

# Parcel 394

## 4 Center St, Municipality of Randolph



**Status:** Active  
**Roll Section:** Taxable  
**Swis:** 047600  
**Tax Map ID #:** 70.063-4-11  
**Account #:** 0800  
**Property Class:** 210 - 1 Family Res  
**Site:** RES 1  
**In Ag. District:** No  
**Site Property Class:** 210 - 1 Family Res  
**Zoning Code:** -  
**Neighborhood Code:** 76010

**Total Acreage/Size:** 42 x 95  
**Land Assessment:** 2014 - \$2,600  
**Full Market Value:** 2014 - \$45,882  
**Living Area:** 1,828 sq. ft.  
**Second Story Area:** 644 sq. ft.  
**Finished Basement:** 0 sq. ft.  
**Building Style:** Old style  
**Bedrooms:** 4  
**Fireplaces:** 0  
**Porch Type:** Porch-covered  
**Overall Condition:** Fair  
**Year Built:** 1940

**School District:** Randolph  
**Total Assessment:** 2014 - \$39,000

**First Story Area:** 1,184 sq. ft.  
**Half Story Area:** 0 sq. ft.  
**Number of Stories:** 2  
**Bathrooms (Full - Half):** 1 - 0  
**Kitchens:** 1  
**Basement Type:** Crawl  
**Porch Area:** 45.00  
**Overall Grade:** Average

Structure	Size	Grade	Condition	Year
Porch-covered	9 x 5	Average	Fair	1900
Porch-enclosed	19 x 13	Average	Fair	0
Porch-covered	100 sq ft	Average	Normal	1940

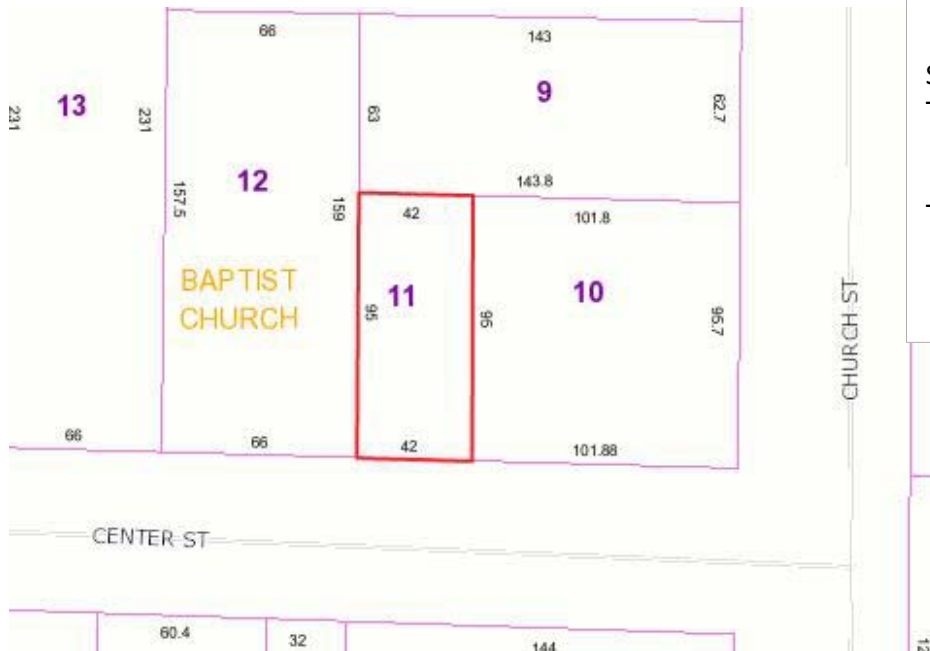

### Approximate Yearly Taxes

School	\$502
Town/County	\$1148
<b>Total</b>	<b>\$1650</b>