

# Parcel 253

2713 Smith Hollow Rd (Off), Municipality of Hinsdale



**Status:**  
Active

**Roll Section:**  
Taxable

**Swis:**  
044600

**Tax Map ID #:**  
85.002-1-19.2

**Account #:**  
1208

**Property Class:**  
210 - 1 Family Res

**Site:**  
RES 1

**In Ag. District:**  
No

**Site Property Class:**  
210 - 1 Family Res

**Zoning Code:**

-

**Neighborhood Code:**

46200 - Secondary Roads

**Total Acreage/Size:**

200 x 220

**School District:**

Hinsdale

**Land Assessment:**

2014 - \$6,500

**Total Assessment:**

2014 - \$63,000

**Full Market Value:**

2014 - \$63,000

**Living Area:**

1,260 sq. ft.

**First Story Area:**

840 sq. ft.

**Second Story Area:**

0 sq. ft.

**Half Story Area:**

420 sq. ft.

**Finished Basement:**

0 sq. ft.

**Number of Stories:**

1.5

**Building Style:**

Log home

**Bathrooms (Full - Half):**

1 - 0

**Bedrooms:**

2

**Kitchens:**

1

**Fireplaces:**

1

**Basement Type:**

Slab/pier

**Porch Type:**

Porch-covered

**Porch Area:**

240.00

**Overall Condition:**

Normal

**Overall Grade:**

Average

**Year Built:**

1978

**Structure****Size****Grade****Condition****Year**

Porch-covered

240 sq ft

Average

Normal  
1978

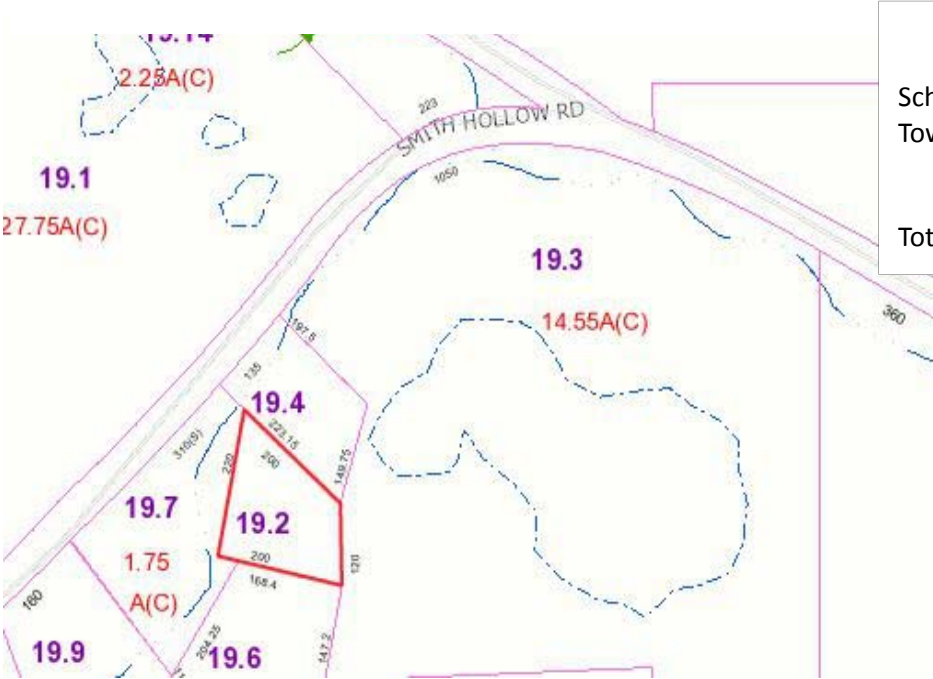

Approximate Yearly Taxes	
School	\$1045
Town/County	\$1380
Total	\$2425