

Parcel 147

541 Main St, Municipality of Carrollton



Status: Active

Roll Section: Taxable
Swis: 042400
Tax Map ID #: 101.079-1-15
Account #: 0706
Property Class: 210 - 1 Family Res
Site: RES 1
In Ag. District: No
Site Property Class: 210 - 1 Family Res
Zoning Code: 01
Neighborhood Code: 24010
School District: Allegany - Limestone
Total Assessment: 2014 - \$38,000

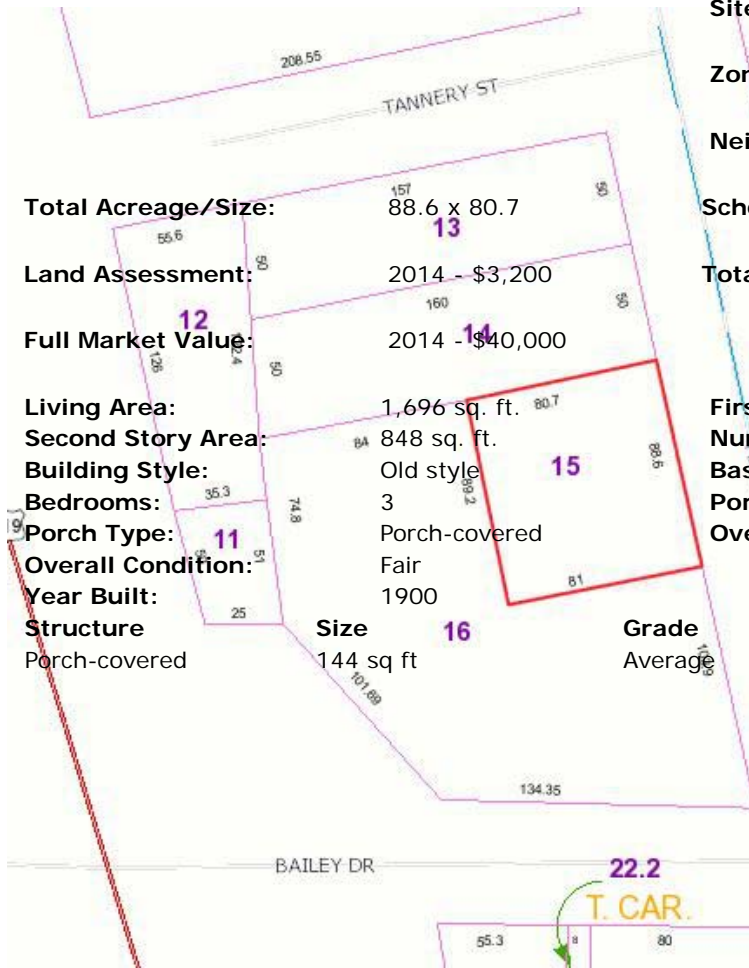

Total Acreage/Size: 88.6 x 80.7
Land Assessment: 2014 - \$3,200
Full Market Value: 2014 - \$40,000
Living Area: 1,696 sq. ft.
Second Story Area: 848 sq. ft.
Building Style: Old style
Bedrooms: 3
Porch Type: Porch-covered
Overall Condition: Fair
Year Built: 1900
Structure: Porch-covered
Size: 144 sq ft
Grade: Average

First Story Area: 848 sq. ft.
Number of Stories: 2
Basement Type: Full
Porch Area: 144.00
Overall Grade: Average

Approximate Yearly Taxes	
School	\$749
Town/County	\$792
Total	\$1541